



# Linear actuator CAT 33

Quick delivery of custom actuators



The CAT modular design makes it easy to create custom actuators suitable for specific applications. Select the critical components: motors, gearing, attachments, etc., to achieve custom performance without custom lead-time.

# Build your custom actuator from

Actuators built using the designation type key guide below are assembled from in-stock components. Usually up to 5 pieces can be made in 5 working days.

Quick delivery of custom CAT actuators is easy as **1, 2, 3**. Select your components to build the designation type key then contact your SKF authorized distributor or sales office to order.

- 1** Determine your base (screw)
- 2** Define stroke
- 3** Specify gearing
- 4** Choose attachments
- 5** Pick options
- 6** Designate motor
- 7** Select feedback option

## Designation type key

Assembly		C	A	T															
Motor mounted right side (ambidextrous) left side			R L																
<b>1</b>	<b>Screw (Tube; aluminum outer and DOSS inner)</b>																		
	Sliding screw TR 12x3 with plastic nut																		
	Ballscrew 12x4 mm																		
	Sliding screw 1/2x1/2 with plastic nut																		
<b>2</b>	<b>Stroke (S)</b>																		
	50 mm																		
	100 mm																		
	150 mm																		
	200 mm																		
	250 mm																		
	300 mm																		
	350 mm																		
	Custom order <50 or >350																		
	(stroke lengths including and over 400 mm have an additional 50 mm added to retracted length)																		
<b>3</b>	<b>Gear designator</b>																		
	Ratio 1:25																		
	Ratio 1:12,5 – not self-locking in 33H and 33B w/o brake																		
	Ratio 1:6,25 – not self-locking in 33H and 33B w/o brake																		
<b>4</b>	<b>Rear attachment</b>																		
	Fork (clevis) ear w/cross hole d=12,0 mm																		
	Fork (clevis) ear w/cross hole d=12,7 mm																		
	Single ear w/cross hole d=12,0 mm																		
	Single ear w/cross hole d=12,7 mm																		
	**Custom, fork ear																		
	**Custom, single ear																		
<b>4</b>	<b>Front attachment</b>																		
	Cross hole d=12,0 mm																		
	Cross hole d=12,7 mm																		
	Male thread, M12x1,75																		
	Female thread, M12x1,75																		
	Fork ear, d=10,1 mm																		
	**Custom order																		
<b>5</b>	<b>Options</b>																		
	Friction clutch (slips when force exceeded)																		
	No friction clutch (e.g. when using an encoder)																		
	Backup wire in ball nut (standard for all ball screw units)																		
<b>6</b>	<b>Motor</b>																		
	Without motor (typically when replacing just the actuator)																		
	DC motors rated IP44																		
	12 VDC standard w/24" wires																		
	12 VDC half speed w/24" wires																		
	24 VDC standard w/24" wires																		
	24 VDC half speed w/24" wires																		
	90 VDC standard w/24" wires																		
	90 VDC half speed w/24" wires																		
	12 VDC flat motor standard w/12" wires																		
	24 VDC flat motor standard (with brake)																		
	24 VDC flat motor with extended shaft																		
	AC motors rated IP54																		
	110 VAC (with brake) single phase 50/60 Hz PSC type (requires starting capacitor)																		
	220 VAC (with brake) single phase 50/60 Hz PSC type (requires starting capacitor)																		
	380 VAC 3-phase delta connected																		
<b>7</b>	<b>Feedback option</b>																		
	Encoder – 2PPR (pulse-per-revolution of the motor)																		
	No encoder																		

\*\* Custom made to customer specifications (G0, A0 and K0). When custom features are selected this will affect lead time. Please consult technical team.

# om CAT modular components

## 1 Base (screw)

For easy selection, three basic actuators form the base for the CAT modular range.

- CAT 33 sliding screw, standard
- CAT 33H sliding screw, high speed
- CAT 33B SKF ball screw, for higher load and/or duty factors

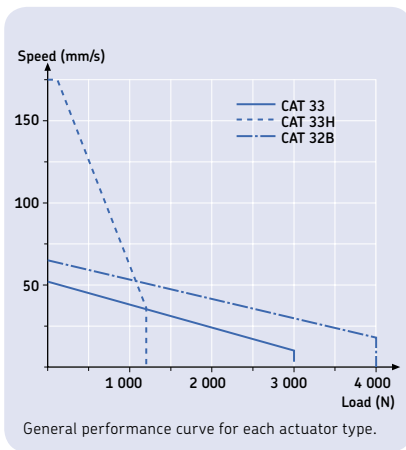

## 6 Motors

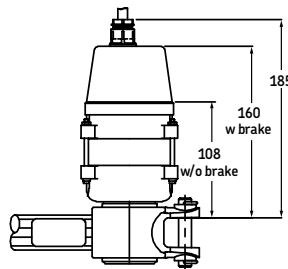

Optional AC motor  
E110C, E110CB, E220C, E220CB

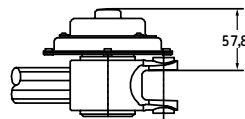

Optional flat style motor  
D12C, D24C, D24CB, D24CS

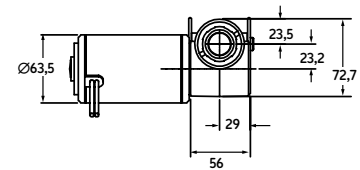
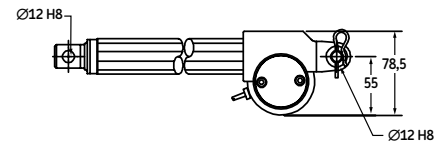
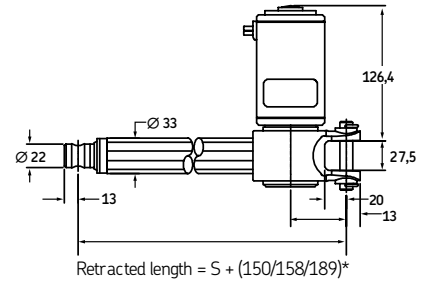

Optional cylindrical style motor  
C12CTT, C12CWT T, C24CT T, C24CWT T,  
C90CTT, C90CWT T

\* dimension depends on selected front attachment

## 4 Attachments

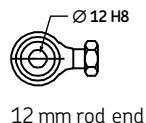
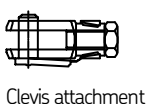
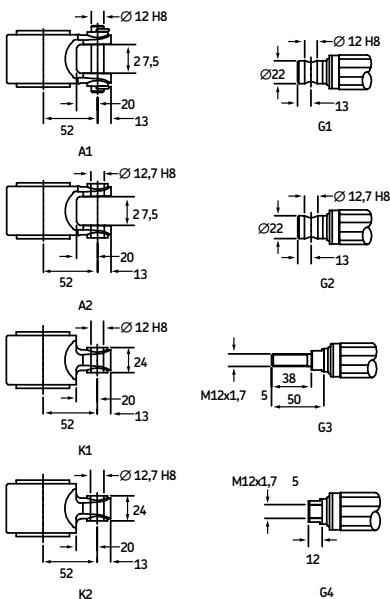

## 7 Encoder

- Can be fitted to all standard motors
- Hall effect, 2 channels with 90° displacement
- Located on gear housing, see drawing
- 2 pulses/channel and motor revolution
- Supply voltage: 5 to 24 VDC
- Current output: max. 12,5 mA
- Final resolution according to gear ratio and actuator basic type (see table)

### Feedback

	gear	pulses/mm	mm/pulse
CAT 33	1	16,67	0,06
	2	8,33	0,12
	4	4,17	0,24
CAT 33H	1	4,00	0,25
	2	2,00	0,50
	4	1,00	1,00
CAT 33B	1	12,50	0,08
	2	6,25	0,16
	4	3,13	0,32

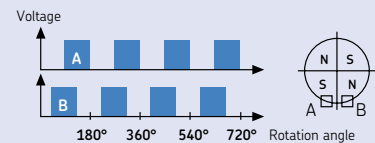

Encoder option E

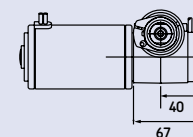

## Temperatures

Actuators can normally be used within a temperature range -20 °C (-5 °F) to +50 °C (122 °F). All performance data stated in this catalog are only valid at +20 °C (68 °F).

## Duty factor

- Design for intermittent operation
- Permitted load related to duty factor, e.g. the higher the load, the less the permitted duty factor
- Duty factor is defined as running time under load versus total cycle time
- The diagram shows load as function of duty cycle
- For AC motors the capacitor must be selected with respect to the duty cycle and load. Required capacitor size is indicated in diagram

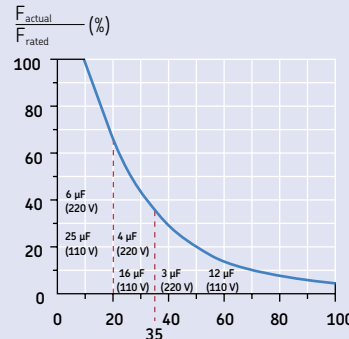

$$\text{Duty factor \%} = \frac{N \times 100}{N + R}$$

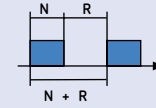

N = running time  
R = rest period  
N + R = total cycle time

## Typical limit switches/wiring diagram

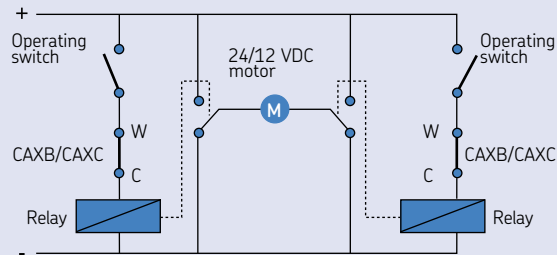

## Optional CAXC 33 shown here

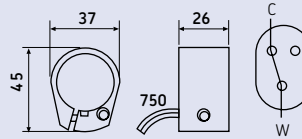

Permissible break power: 3 W  
Max. break voltage 200 VDC  
Max. break current 200 mA DC  
W = Common  
C = Normally closed



Please contact your SKF sales representative to find out more about our Quick Delivery range program



SKF USA Inc.  
1530 Valley Center Parkway  
Bethlehem, PA 18017, 800-541-3624  
fax 610-861-3737  
www.skfusa.com/linearactuators

© SKF is a registered trademark of the SKF Group.

© SKF Group 2007.

The contents of this publication are the copyright of the publisher and may not be reproduced (even extracts) unless prior written permission is granted. Every care has been taken to ensure the accuracy of the information contained in this publication but no liability can be accepted for any loss or damage whether direct, indirect or consequential arising out of the use of the information contained herein.

